



Reading Pickleball Courts on Range Road

Activitas
BH+A

March 4, 2025
38

Existing Conditions



ReCAL and Pickleball Site

Conservation Land / Wetland

Existing Conditions



Forest Mat & Topsoil Removal required at this site



MASTER PLAN LEGEND

- 1 NEW CORNER FOR ATHLETIC CENTER BUILDING
- 2 NEW HOCKEY COURT - 7' IDEAL COVER
3' WIDE WALKWAY (100' x 100')
- 3 NEW PARKING LOT AT CAL BUILDING
TOTAL 100' x 100' x 10' x 10'
- 4 FOOTBALL W/THROWING AREA
- 5 NEW WETLAND BOARDWALK
- 6 RANGE ROAD EXTENSION TO FORM
FOOTBALL COURT PROJECT
- 7 NEW OUTDOOR STAMPEDE AREA
- 8 NEW OUTDOOR FACILITY AREA
FOR W/THROWING AREA (100' x 100')
- 9 NEW ROAD CONNECTION
AT BEAR LAKE ICE ARENA PARKING LOT





The site soil is Unconsolidated Glacial Deposits

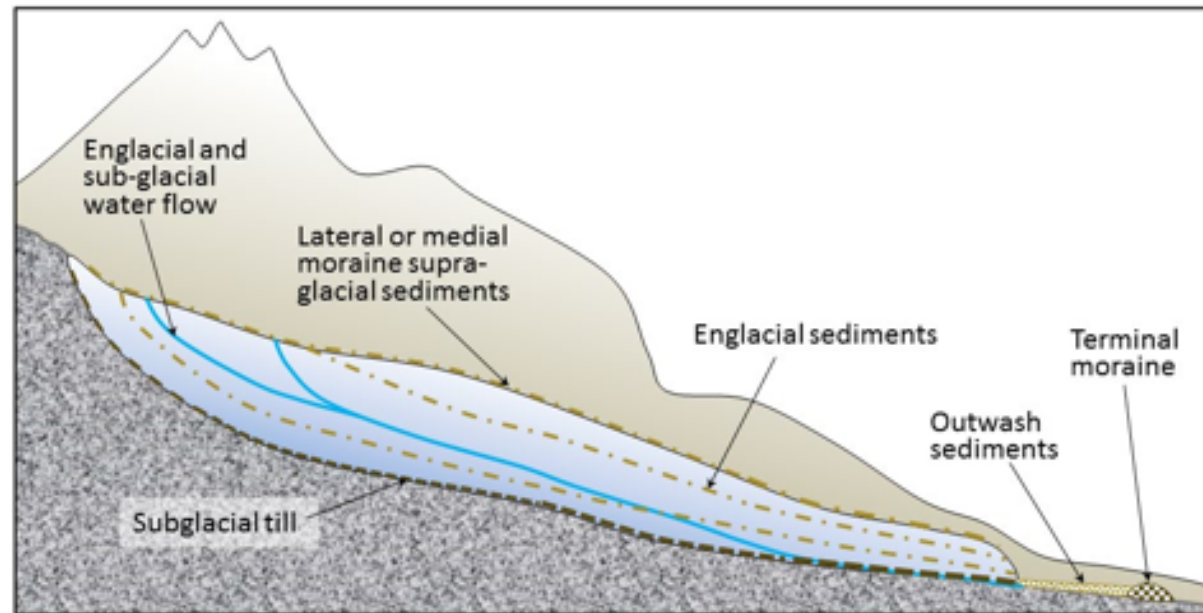

Forest Mat & Topsoil Removal required at this site



Post Tensioned Concrete Court due to soil conditions

Post tension utilizes steel cables in a grid pattern that are elevated so that when the concrete is poured, the cables run through the middle of the slab. The slab cures after which the cables are tensioned. The cables take static tension off the concrete. This makes for a more stable and durable surface over time.

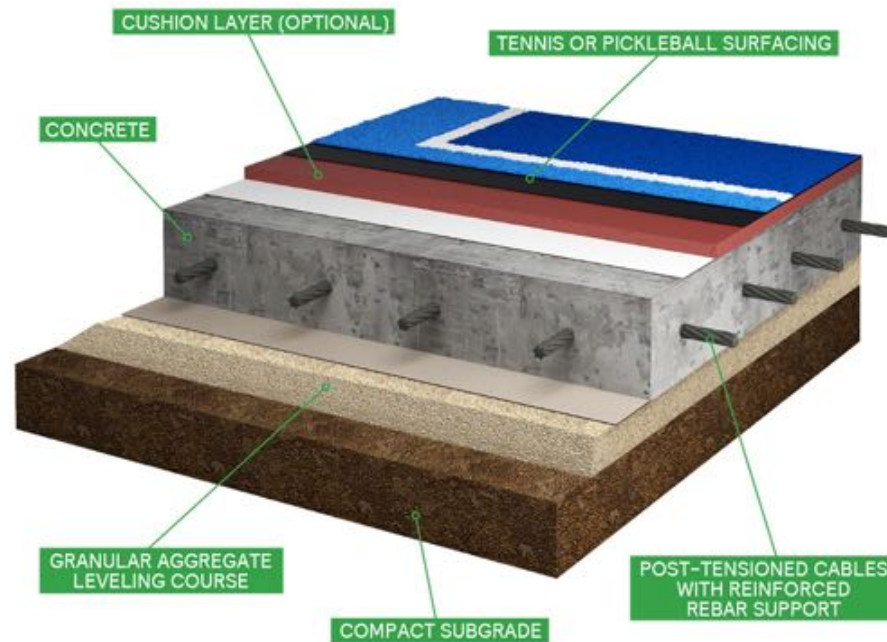

Asphalt Courts



Asphalt courts are made by installing a layer of asphalt on top of a cushion of gravel, then applying an acrylic coating generally over a fiberglass inter layer. These courts are not as durable from a life cycle perspective, especially when installed over this type of soil.

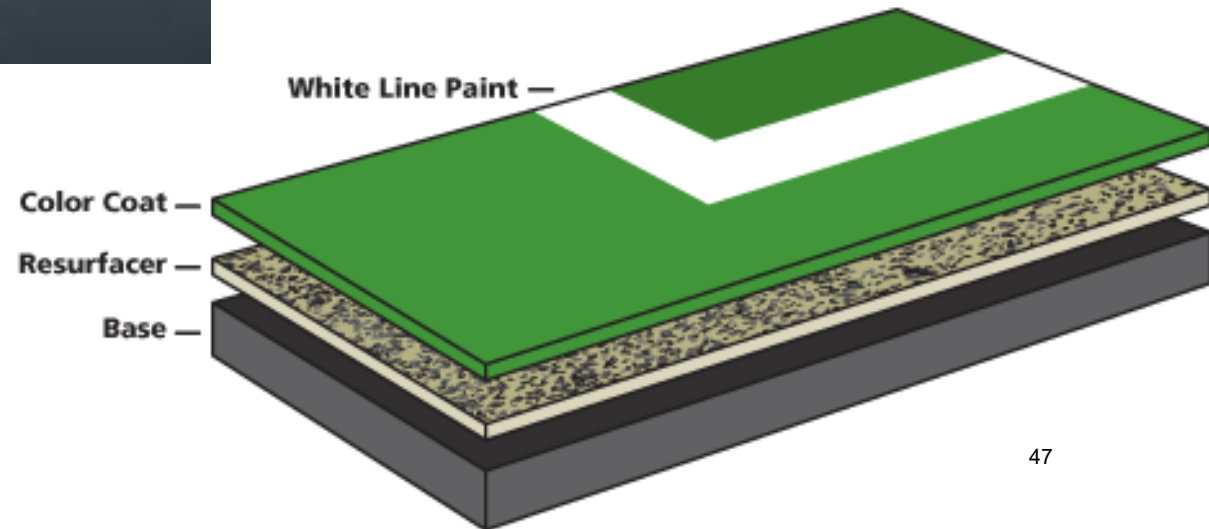

Proposed Phasing Plan

(Assuming funding for both is available)

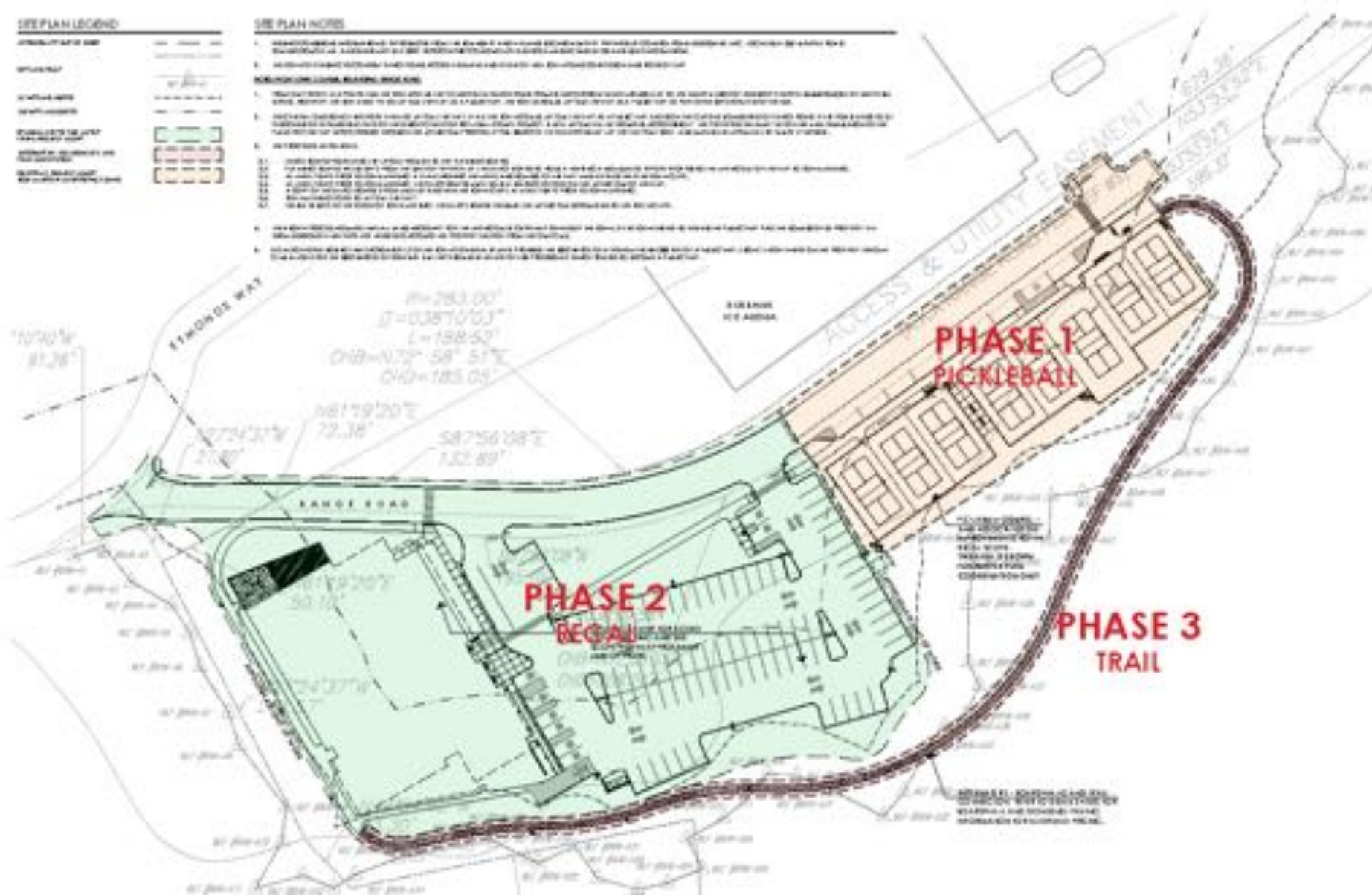

Project Phasing Scenario No. 2



Precedent Images: Lighting



Cost

Total Project Cost: \$1,894,000 inclusive of all project costs & contingency

included:

- Pickleball site master plan as shown
- 7 courts one of which is a fully accessible court
- Post tensioned concrete court surfaces
- Lighting
- Connection to Burbank Arena rear parking area



Questions?